

# Seabourn Odyssey Seabourn Sojourn Seabourn Quest

## DECK PLANS

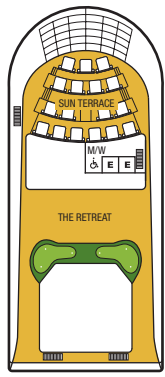

DECK 11

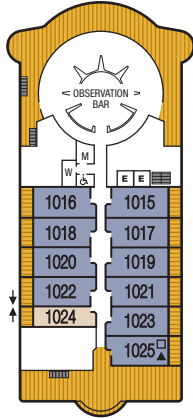

DECK 10

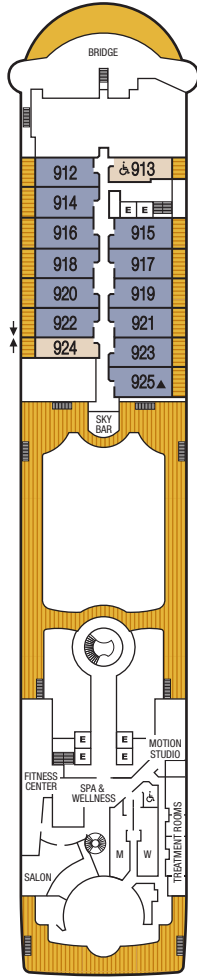

DECK 9

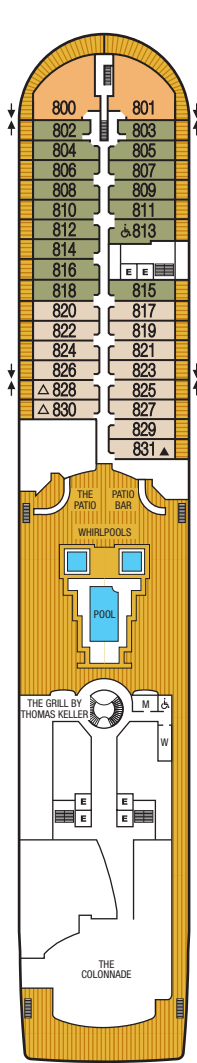

DECK 8

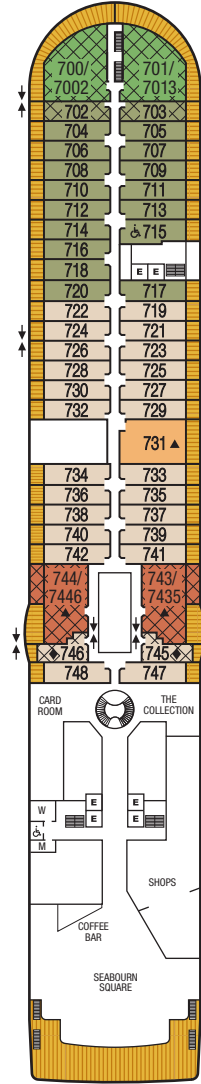

DECK 7

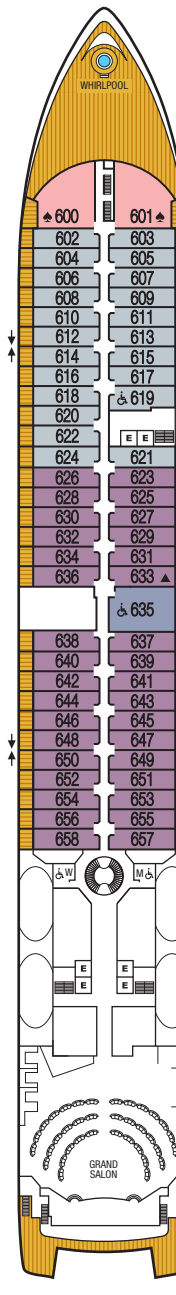

DECK 6

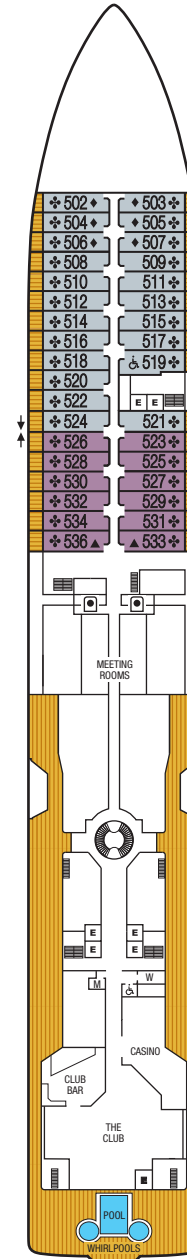

DECK 5

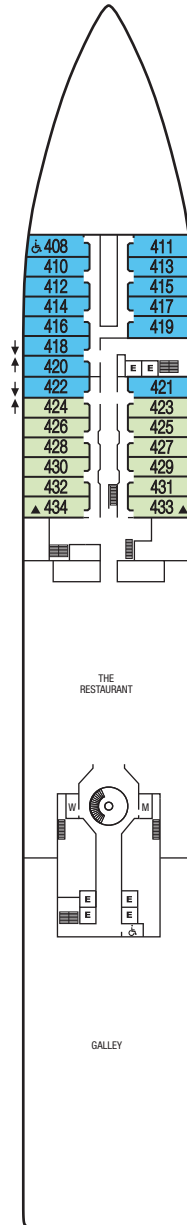

DECK 4

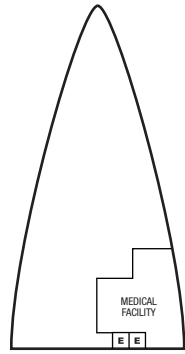

DECK 3

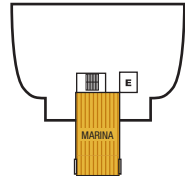

DECK 2

### Connecting Suites

When combining the following suites, their suite numbers change as follows:  
 Suites 701 and 703 become Grand Signature Suite 7002;  
 suites 701 and 703 become Grand Signature Suite 7013;  
 suites 743 and 745 become Grand Wintergarden Suite 7435;  
 suites 744 and 746 become Grand Wintergarden Suite 7446.

### Wheelchair Accessible Suites

Suites 408, 519, 619, 635, 715, 813 & 913 are wheelchair accessible—roll-in shower only, wheelchair-accessible doorways. Suite 635 also has a tub.

♣ Suites 600 and 601 are subject to noise when anchoring and the veranda railings are part metal and part glass from floor to teak rail.

△ Suite 828 third guest capacity for Seabourn Sojourn only

△ Suite 830 third guest capacity for Seabourn Odyssey and Seabourn Quest only

▲ Third Guest Capacity Suite

■ Elevator

■ Self Service Launderette

◆ Suites 502–507 and 745–746 have smaller verandas

□ Suite 1025 has a partially obstructed veranda view

♣ The veranda railings in categories V1 and V2 are part metal and part glass from floor to teak rail

❖ Suites 1090, 1091, 1092, & 1093 are only accessible via a staircase

Deck plan shown is for illustration purposes. Seabourn reserves the right to make amendments and changes. Effective 11/15/20.

### SUITE CATEGORIES

GR	WG	SS	O2	O1	PS	PH
V4	V3	V2	V1	A1	A	

